

STAINLESS STEEL WORKTABLES

EF1-SERIES — ENCLOSED TABLE W/ BACKSPLASH & UNDERSHELF

PROJECT#: _____

ITEM# _____

MODEL# _____

SPECIFICATIONS:

ECONOMY—EEF1-Series: 400 Series Stainless Top, 400 Series Stainless Body & 400 Series Stainless Undershelf

TOP: 16 GA.
400 Series Stainless
SHELF: 18 GA.
400 Series Stainless
BODY: 20 GA.
400 Series Stainless
LEGS: 1 1/2" Square
Tubular Stainless Steel

STANDARD—SEF1-Series: 300 Series Stainless Top, 300 Series Stainless Body & 300 Series Stainless Undershelf

TOP: 16 GA.
300 Series Stainless
SHELF: 18 GA.
300 Series Stainless
BODY: 20 GA.
300 Series Stainless
LEGS: 1 1/2" Square
Tubular Stainless Steel

HEAVY DUTY—HEF1-Series: 300 Series Stainless Top, 300 Series Stainless Body & 300 Series Stainless Undershelf

TOP: 14 GA.
300 Series Stainless
SHELF: 16 GA.
300 Series Stainless
BODY: 18 GA.
300 Series Stainless
LEGS: 1 1/2" Square
Tubular Stainless Steel

CONSTRUCTION:

- ◆ All Table Connection Points Fully Welded for Maximum Rigidity and Long Life
- ◆ S/S Adjustable Bullet Feet
- ◆ Sound Deadening Between Top and Reinforcing Channel
- ◆ Offsets on Body Ends for Flush Fit
- ◆ S/S Undershelf Welded to Legs
- ◆ Table is Polished to #3 Finish
- ◆ Working Height 35" to 36 1/4"



○ Amtekco Industries - Columbus, OH —Phone: (800) 336-4677

○ N. Wasserstrom & Sons - Columbus, OH —Phone: (800) 444-4697

○ DCS IV - Peoria, AZ—Phone: (800) 592-3274

○ GEN III - Fountain Inn, SC—Phone: (800)673-3339

○ GKS - Garland, TX—Phone (972) 485-4579

SPECIFICATIONS SUBJECT TO CHANGE WITHOUT NOTICE 01/09

ECONOMY - EEF1 - SERIES						
24" WIDE	QTY	30" WIDE	QTY	36" WIDE	QTY	LENGTH (INCHES)
EEF1-2424		EEF1-3024		EEF1-3624		24
EEF1-2430		EEF1-3030		EEF1-3630		30
EEF1-2436		EEF1-3036		EEF1-3636		36
EEF1-2442		EEF1-3042		EEF1-3642		42
EEF1-2448		EEF1-3048		EEF1-3648		48
EEF1-2454		EEF1-3054		EEF1-3654		54
EEF1-2460		EEF1-3060		EEF1-3660		60
EEF1-2466		EEF1-3066		EEF1-3666		66
EEF1-2472		EEF1-3072		EEF1-3672		72
EEF1-2478		EEF1-3078		EEF1-3678		78
EEF1-2484		EEF1-3084		EEF1-3684		84
EEF1-2490		EEF1-3090		EEF1-3690		90
EEF1-2496		EEF1-3096		EEF1-3696		96
EEF1-24102		EEF1-30102		EEF1-36102		102
EEF1-24108		EEF1-30108		EEF1-36108		108
EEF1-24114		EEF1-30114		EEF1-36114		114
EEF1-24120		EEF1-30120		EEF1-36120		120
STANDARD - SEF1 - SERIES						
24" WIDE	QTY	30" WIDE	QTY	36" WIDE	QTY	LENGTH (INCHES)
SEF1-2424		SEF1-3024		SEF1-3624		24
SEF1-2430		SEF1-3030		SEF1-3630		30
SEF1-2436		SEF1-3036		SEF1-3636		36
SEF1-2442		SEF1-3042		SEF1-3642		42
SEF1-2448		SEF1-3048		SEF1-3648		48
SEF1-2454		SEF1-3054		SEF1-3654		54
SEF1-2460		SEF1-3060		SEF1-3660		60
SEF1-2466		SEF1-3066		SEF1-3666		66
SEF1-2472		SEF1-3072		SEF1-3672		72
SEF1-2478		SEF1-3078		SEF1-3678		78
SEF1-2484		SEF1-3084		SEF1-3684		84
SEF1-2490		SEF1-3090		SEF1-3690		90
SEF1-2496		SEF1-3096		SEF1-3696		96
SEF1-24102		SEF1-30102		SEF1-36102		102
SEF1-24108		SEF1-30108		SEF1-36108		108
SEF1-24114		SEF1-30114		SEF1-36114		114
SEF1-24120		SEF1-30120		SEF1-36120		120
HEAVY DUTY - HEF1 - SERIES						
24" WIDE	QTY	30" WIDE	QTY	36" WIDE	QTY	LENGTH (INCHES)
HEF1-2424		HEF1-3024		HEF1-3624		24
HEF1-2430		HEF1-3030		HEF1-3630		30
HEF1-2436		HEF1-3036		HEF1-3636		36
HEF1-2442		HEF1-3042		HEF1-3642		42
HEF1-2448		HEF1-3048		HEF1-3648		48
HEF1-2454		HEF1-3054		HEF1-3654		54
HEF1-2460		HEF1-3060		HEF1-3660		60
HEF1-2466		HEF1-3066		HEF1-3666		66
HEF1-2472		HEF1-3072		HEF1-3672		72
HEF1-2478		HEF1-3078		HEF1-3678		78
HEF1-2484		HEF1-3084		HEF1-3684		84
HEF1-2490		HEF1-3090		HEF1-3690		90
HEF1-2496		HEF1-3096		HEF1-3696		96
HEF1-24102		HEF1-30102		HEF1-36102		102
HEF1-24108		HEF1-30108		HEF1-36108		108
HEF1-24114		HEF1-30114		HEF1-36114		114
HEF1-24120		HEF1-30120		HEF1-36120		120

STAINLESS STEEL WORKTABLES

EF1-SERIES — ENCLOSED TABLE W/ BACKSPLASH & UNDERSHELF

PROJECT#: _____

ITEM# _____

MODEL# _____

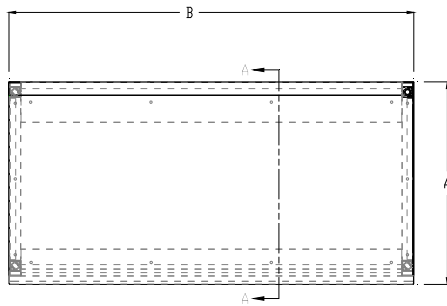

PLAN VIEW

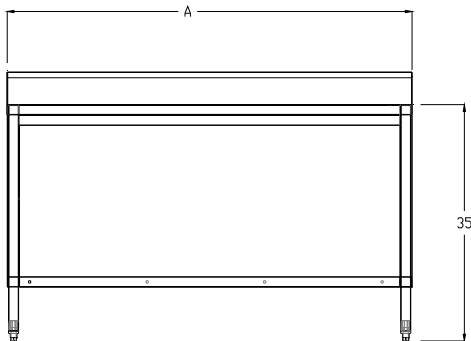

ELEVATION

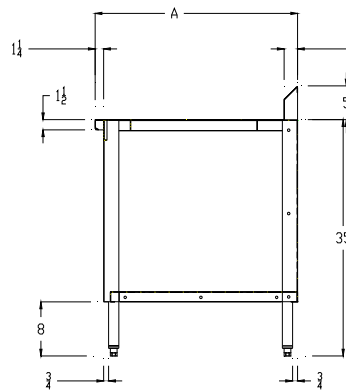

SIDE VIEW

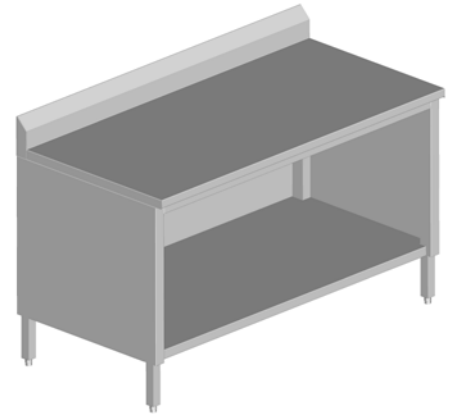

- ◆ 35" Working Height is with Adj. Bullet Feet in Shortest Position
- ◆ Tables At or Above 78" Will Require (3) Sets of Legs.

A WIDTH	B LENGTH	EEF1 - SERIES 16 GA. 400 SERIES S/S TOP & 18 GA. 400 SERIES S/S UNDERSHELF	SEF1 - SERIES 16 GA. 300 SERIES S/S TOP & 18 GA. 300 SERIES S/S UNDERSHELF	HEF1 - SERIES 14 GA. 300 SERIES S/S TOP & 16 GA. 300 SERIES S/S UNDERSHELF	#Of Legs	Product Weight (lbs)
24" WIDE						
24	24	EEF1-2424	SEF1-2424	HEF1-2424	4	96
24	30	EEF1-2430	SEF1-2430	HEF1-2430	4	118
24	36	EEF1-2436	SEF1-2436	HEF1-2436	4	139
24	48	EEF1-2448	SEF1-2448	HEF1-2448	4	166
24	60	EEF1-2460	SEF1-2460	HEF1-2460	4	194
24	72	EEF1-2472	SEF1-2472	HEF1-2472	4	222
24	84	EEF1-2484	SEF1-2484	HEF1-2484	6	249
24	96	EEF1-2496	SEF1-2496	HEF1-2496	6	277
24	108	EEF1-24108	SEF1-24108	HEF1-24108	6	304
24	120	EEF1-24120	SEF1-24120	HEF1-24120	6	332
30" WIDE						
30	24	EEF1-3024	SEF1-3024	HEF1-3024	4	89
30	30	EEF1-3030	SEF1-3030	HEF1-3030	4	113
30	36	EEF1-3036	SEF1-3036	HEF1-3036	4	136
30	48	EEF1-3048	SEF1-3048	HEF1-3048	4	165
30	60	EEF1-3060	SEF1-3060	HEF1-3060	4	195
30	72	EEF1-3072	SEF1-3072	HEF1-3072	4	225
30	84	EEF1-3084	SEF1-3084	HEF1-3084	6	254
30	96	EEF1-3096	SEF1-3096	HEF1-3096	6	284
30	108	EEF1-30108	SEF1-30108	HEF1-30108	6	313
30	120	EEF1-30120	SEF1-30120	HEF1-30120	6	343
36" WIDE						
36	24	EEF1-3624	SEF1-3624	HEF1-3624	4	114
36	30	EEF1-3630	SEF1-3630	HEF1-3630	4	141
36	36	EEF1-3636	SEF1-3636	HEF1-3636	4	167
36	48	EEF1-3648	SEF1-3648	HEF1-3648	4	199
36	60	EEF1-3660	SEF1-3660	HEF1-3660	4	232
36	72	EEF1-3672	SEF1-3672	HEF1-3672	4	265
36	84	EEF1-3684	SEF1-3684	HEF1-3684	6	297
36	96	EEF1-3696	SEF1-3696	HEF1-3696	6	330
36	108	EEF1-36108	SEF1-36108	HEF1-36108	6	362
36	120	EEF1-36120	SEF1-36120	HEF1-36120	6	395